

TOUCHBeauty





SKU24593

REMs Beauty Device
Instruction Manual



- ✘ Important Notice: This manual is available in two languages: English and Simplified Chinese. If any dispute or confusion arises caused by the translation, the English version shall prevail.
- ✘ To ensure the proper operation of this device, please read this instruction manual carefully before using the device and keep it for further reference.

WARNINGS

-  This device is not designated for use as a toy and is not suitable for children to use or play with. Please ensure it is kept out of children's reach.
-  Prior to usage, always verify the condition of the device. Do not use it if it's damaged or broken.
-  If used in a dry environment, handling this device may generate static electricity. This is normal and does not affect its use.
-  Keep the USB charging cable and the device's charging terminal dry.

PRECAUTIONS

-  Do not use this device in the following situations:
 - Pregnant women or while nursing; children; persons who have a pacemaker or other electronic medical equipment; persons with allergic reactions.

- If the treatment area has skin conditions, such as open wounds, ringworm, eczema, rash, burns, sunburns, abnormal wound healing, etc; with makeup on.
- If you have diabetes, systemic lupus erythematosus, porphyria, or congestive heart failure, as well as those with bleeding disorders, a history of immunosuppressive conditions (including HIV infection or AIDS).
- If you have medical electronic equipment like a pacemaker or internal defibrillator, please do not use this device. Additionally, do not use it if you have an arrhythmia or a diagnosed heart condition.
- If you have metal implants, piercings, or any suspicious skin lesions in the area of application, please do not use this device.
- Do not use this device if you are currently undergoing radiation therapy or chemotherapy treatments.
- Do not use this device if you have any condition that can be triggered by thermal stimulation, such as recurrent herpes simplex virus infections.
- 🚫 Do not use this device if you take any of the following medications:
 - If your skin is currently being treated with or has recently been treated with Alpha-Hydroxy Acids (AHAs), Beta-Hydroxy Acids (BHAs), topical isotretinoin, and azelaic acid.
 - If you have taken any form of Accutane A or Roaccutane A within the past six months.

- If you are on photosensitizing agents or any other medication prescribed by a doctor, please review the patient information leaflet before using this device. If the patient information leaflet mentions potential photo-allergic or photo-toxic reactions, or advises avoiding sun exposure while taking the medication, please do not use the device.

- If you're taking anticoagulant medication, including high doses of aspirin, please wait for at least one week after discontinuing the treatment before using the device.

- 👁️ This device is intended for use on the face (forehead, cheeks, chin). Do not use it on the eyelids, lips, chest, genital area, throat, or on areas where you have undergone surgery or epilation.

- 👁️ If your skin is sensitive to light and prone to developing rashes or allergic reactions, please do not use the light therapy mode.

- 👁️ Avoid direct eye contact with the LED light source. Do not use the light therapy mode if the treatment area has infections, eczema, burns, inflammation of hair follicles, open lacerations, herpes, wounds, lesions, or hematomas.

- 👁️ Do not attempt to repair, disassemble, or modify the device on your own, nor use this device for purposes other than intended.

- 👁️ If you experience discomfort during use, immediately discontinue use and consult a doctor.

- 👁️ Regularly clean the device surface and accessories to prolong its lifespan.

⚠ It is recommended to use a gel that is compatible with this device (purchase separately). Using other creams or gels may affect the normal operation of this device and its microelectronics function.

Device Description

TB-2382

⚠ Device Specifications

Name: REMs Beauty Device

Model No.: TB-2382

Input: 5V=1A

Type of Battery: Li-ion 3.7V 1050mAh

Executive Standard: Q/XM 1021-2020

⚠ Device Components (Picture 1)

- | | |
|-----------------------------|----------------------|
| ① Main Unit | ④ Cleaning Cloth |
| ② Protective Cap (Magnetic) | ⑤ Storage Bag |
| ③ Charging Cable | ⑥ Instruction Manual |

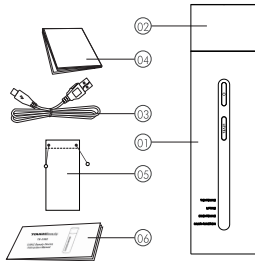

Picture 1

👤 Device Features (Picture 2)

- ① Face Massage Head
- ② ON-OFF/Mode Switch Button
- ③ Intensity Level Button
- ④ Mode Indicators Light
- ⑤ Intensity Level Indicators Light
- ⑥ Type-C Charging Terminal

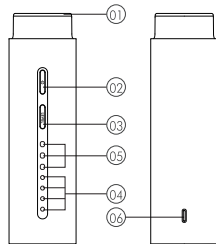

Picture 2

Preparing for Use TB-2382

※ The battery is low before you use the device for the first time. Charge the device with the USB cable to fully charge the device before regular use.

☹️ Charging Instructions

- This device utilizes a USB charging system. Prior to charging, connect the charging cable to the device's charging terminal and to an adapter (adapter not included; choose a high-rated adapter with 1A output as indicated on the device label). Plug the adapter into a power source to start charging the device. (Picture 3)

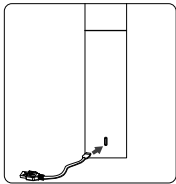

Picture 3

- When charging, the intensity level indicators light up in a cycle. Once fully charged, the intensity level indicators light up continuously. (Picture 4)

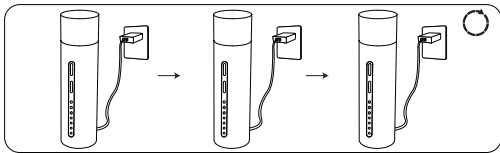

Picture 4

- Charging the device takes 2-3 hours. A full battery allows for ≥ 60 minutes of continuous use.
- When the device is running out of battery, the mode and intensity level indicators flash five times simultaneously, prompting an automatic shutdown of the device.

🔊 Turn ON-OFF & Mode Switch

The ON-OFF/Mode Switch and intensity level buttons are designed vertically as fingertip buttons for convenient use. The upper button functions as an ON-OFF and mode switch button. Press it for one second to power ON the device, you'll hear a prompt "DO RE MI" sound. A Short press on the same button enables easy mode adjustment in a cycle. You can choose between 4 different modes. To power OFF the device, press the button for 1 second, and you will hear a "DO RE" sound. The lower button allows you to adjust the intensity level from 1 to 3 in a cycle.

※ Please consult the table below for proper device operation instructions:

Mode	Mode Overview	Operating Method	Mode Adjustment	Intensity Level Adjustment	Operation Status
Power ON-OFF	Press & hold		\	\	Press & hold for 1S to switch ON with a prompt "DO RE MI" sound. Press & hold for 1S to switch OFF with a prompt "DO RE" sound.
TIGHTENING	Firming Mode REMs	After initial power ON	Mode indicator lights up (default mode)	The intensity level indicator lights up (default is level 1). Press to adjust the intensity level from 1-3.	Works for 6 minutes
LIFTING	Lifting Mode Ms+Red Light Therapy	Press the mode button once	Mode indicator light switches	The intensity level indicator lights up. Press to adjust from levels 1-3 according to your needs.	Works for 6 minutes
BRIGHTENING	Brightening Mode Es+Red Light Mode	Press the mode button once	Mode indicator light switches	The intensity level indicator lights up. Press to adjust from levels 1-3 according to your needs.	Works for 6 minutes
MULTI-FUNCTION	Multifunctional Mode REMs+Red Light Therapy	Press the mode button once	Mode indicator light switches	The intensity level indicator lights up. Press to adjust from levels 1-3 according to your needs.	Works for 8 minutes