

Crystal Microdermabrasion Machine German Motor User Manual



Spa & Equipment SKINACT

Toll Free: 1.800.418.0830

www.skinact.com
www.spaandequipment.com

International: 818.834.6640

NOTICE

No part of this document may be photocopied, reproduced, or translated into any other language without prior written consent of Spa and Equipment/SkinAct.

The information in this document is subject to change without notice at any time and should not be construed as a commitment by Spa and Equipment/SkinAct.

Spa and Equipment/SkinAct assumes no responsibility for any errors that may be in this document, nor does it make expressed or implied warranty with regard to this material, including, but not limited to, the implied warranties of merchantability and fitness for a particular purpose.

Spa and Equipment/SkinAct shall not be liable for incidental or consequential damages arising out of the furnishing, performance, or use of this document and the program material which it describes.



Toll Free: 1.800.418.0830

www.skinact.com
www.spaandequipment.com

International: 818.834.6640

Preface

Congratulations on your purchase of the Crystal Microdermabrasion Machine With German Motor from SkinAct Inc. We hope this unit brings maximum efficiency and convenience to your salon or spa and quickly becomes a true asset to your skincare business.

This manual is intended to assist your staff in assembling and using the machine properly.

We urge you to read this manual thoroughly before operating the unit.

Note: The Crystal Microdermabrasion Machine is intended for professional use only. Please check with the licensing board in your state to obtain specific certification requirements for operating this equipment.

This manual is not intended to replace classroom instruction for skin care procedures, nor is it intended to replace proper Esthetics or Cosmetology training for the use of general skincare equipment. We thank you for your purchase and hope you enjoy the Crystal Microdermabrasion Machine.

Precautions

- * Please follow the instructions in this manual carefully.
- * Never operate the machine if one or more of the filters is missing.
- * Keep an eye on all the filters. Replace any filters that become too dirty to clean. Ensure replacement filters are the same kind.
- * Always clean the treatment areas on the clients' skin before beginning a treatment.
- * Never introduce moisture, water, oil, dirt, or debris into the machine.
- * This machine is for professional use only.
- * When not in use, ensure the unit is turned off and is unplugged.
- * Do not allow the machine to become wet from water or rain. If it does get wet, turn off and keep unplugged until it has air-dried completely.
- * This machine is not medical equipment, so it should not be assumed that the machine can be used to treat diseases.
- * Ensure children do not play with, on, or around the machine.
- * Do not reuse crystal sand that has been used during previous treatments. Throw away used crystals.
- * It is the owner of this machine's responsibility to determine which clients qualify for dermabrasion treatments and which clients do not qualify.
- * If the power cord is damaged, replace it with the same kind of power cord.
- * All repairs should be performed by a SkinAct technician. Attempting repairs on your own could result in warranty invalidation.

Function and Accessories

Function:

This machine exfoliates the top layer of the epidermis by blasting the skin with aluminum oxide crystals while simultaneously sucking up dead cells and used crystals with a controlled vacuum. Some of the benefits are that the treatment helps diminish wrinkles, smooth the skin, brighten the skin tone, and more.

Accessories:

1. Mainframe
2. Anti-clogging switch
3. Function switch
4. Pressure gauge
5. Power switch
6. Crystal flow adjusting knob
7. Vacuum pressure adjusting knob
8. Crystal recycle socket
9. Crystal output socket
10. Diamond dermabrasion recycle socket
11. Diamond dermabrasion pressure knob
12. Cup mount
13. Top handle
14. Unused crystal cup
15. Used crystal cup
16. Small filtering cup (second air filter)
17. Wand holders
18. Filling cover
19. Filters
20. Crystal funnel
21. Connecting tubes
22. Diamond tips
23. Crystal dermabrasion wand
24. Crystal spraying hole
25. Crystal output tube
26. Crystal recycle tube
27. Diamond dermabrasion wand
28. Rubber seal
29. Power cord socket
30. Tip cleaner
31. Phillips screwdriver
32. Plastic cover for crystal wand head
33. Crystal dermabrasion wand head
34. Cylindrical filter

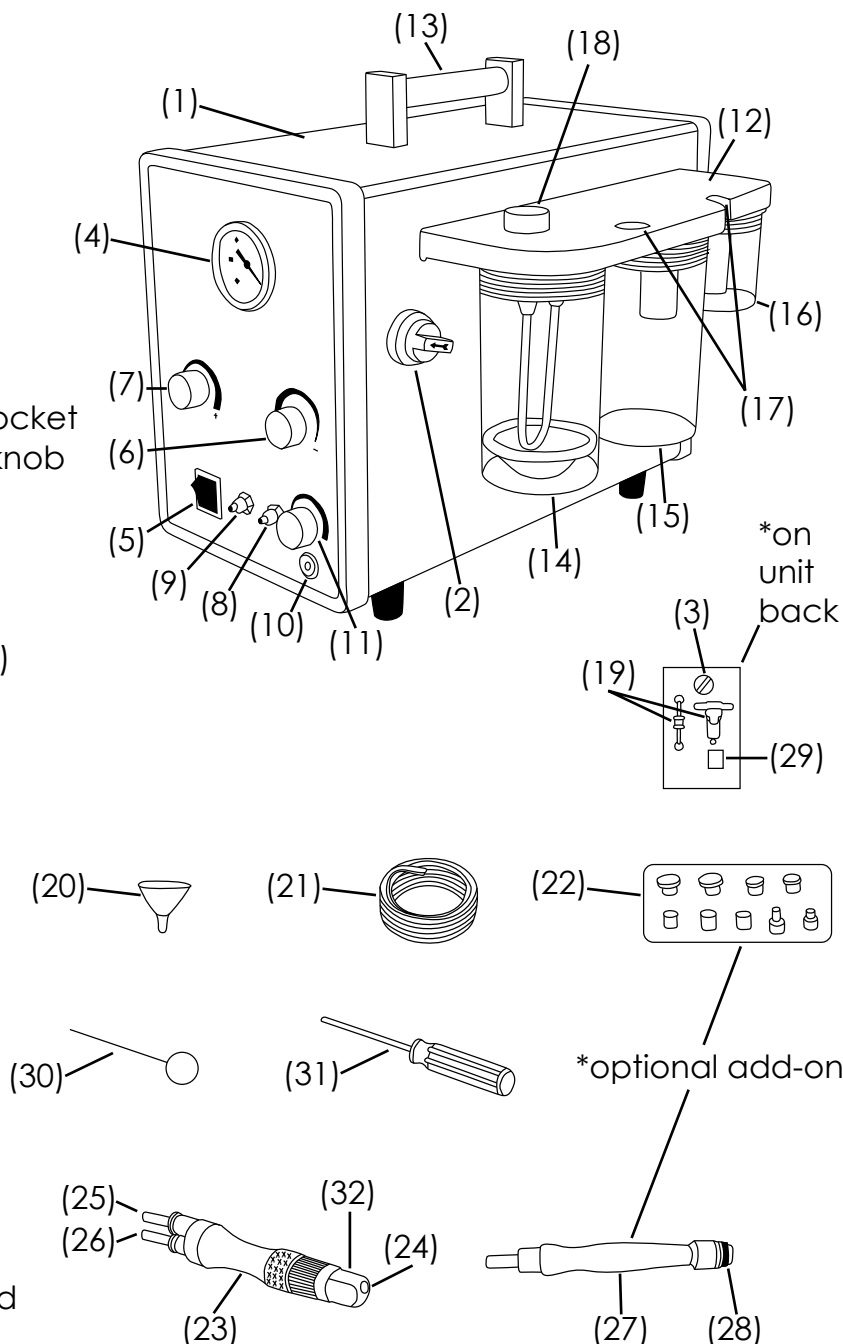

Treatment Procedures

Caution:

Before beginning a treatment, ensure all water, oil, debris, moisture, and/or makeup is cleaned from the treatment areas on your clients' skin.

Crystal microdermabrasion procedure:

1. Make sure the unused crystal cup (14), the used crystal cup (15), the small filtering cup, and all the filters are fixed firmly in place.
2. Open the filling cover (18) and use the funnel (20) to add unused crystals to the unused crystal cup until the cup is about 75% full. Put the filling cover back on and tighten it.
3. Connect the wand tubes to the crystal recycle (8) and crystal output (9) sockets. Tube A connects to socket A: Tube B connects to socket B.
4. Connect the power cord and plug the unit in. Turn on the power switch (5).
5. Switch the function (3) switch on the back of the unit to "Crystal."
6. Set the crystal flow (6) and vacuum pressure (7) knobs to their lowest settings.
7. Take the crystal wand (23) and begin your treatment. Make sure the crystal spraying hole (24) touches the skin and seals well. This will create a vacuum and crystals will be sprayed out. **Note: Excessive force is not necessary. Press just enough for the crystal spraying hole to seal on the clients' skin.**
8. Adjust the crystal flow (6) and vacuum pressure (7) knobs according to your clients' comfort and continue your treatment.
9. Turn off the power switch when the treatment is complete.

Diamond microdermabrasion procedure:

1. Connect the tube (21) to the diamond dermabrasion socket (10) and connect the other end of the tube to the diamond dermabrasion wand (27).
2. Choose a diamond tip (22) and attach it to the diamond dermabrasion wand. Make sure the rubber seal (28) is on the handle.
3. Connect the power cord and plug the unit in. Turn on the power switch (5).
4. Switch the function (3) switch on the back of the unit to "Diamond."
5. Set the pressure knob (11) to its lowest setting.
6. Perform procedure. Adjust the pressure knob according to client comfort.
7. Turn off the power switch when the treatment is complete.

Post Treatment Cleaning

- After each treatment, the plastic cover for the crystal wand head (32) must be removed from the crystal wand, cleaned, and sterilized before it can be used again. Clean the plastic cover with water until it is free of debris. Then sterilize with alcohol or by putting it into a UV sterilizer for 15 to 20 minutes.
- Every diamond tip (22) that was used for a treatment must be removed from the diamond dermabrasion wand, cleaned, and sterilized before it can be used again. Clean the tip(s) under running water and brush with a soft bristled brush. Clean all surfaces until they are free of debris. Then sterilize with alcohol or by putting the tip(s) into a UV sterilizer for 15 to 20 minutes.
- Keep an eye on the used crystal cup and dispose of the used crystals on an as-needed basis. It is best to dispose of them before they reach the bottom of the cylindrical filter.

Cleaning the cylindrical filter:

1. Unscrew the used crystal cup (15) and remove the cylindrical filter (34) (picture 1).
2. Pour out the used crystals and use a soft brush like a toothbrush to clean the cylindrical filter (picture 2). If the filter is too dirty, it can be replaced with a new filter. Make sure to replace with the same kind of filter.
3. Put the cylindrical filter firmly back in place and screw the used crystal cup back on until it is snug (picture 3).

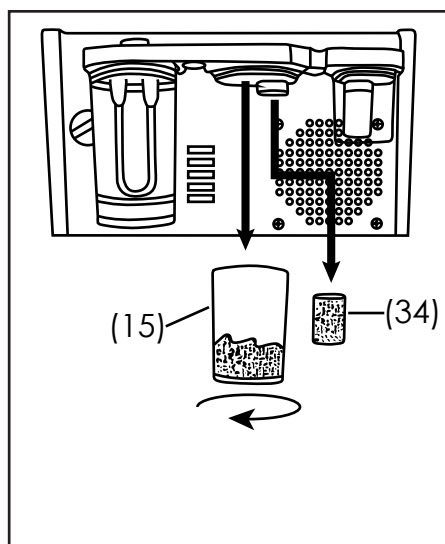

Picture 1

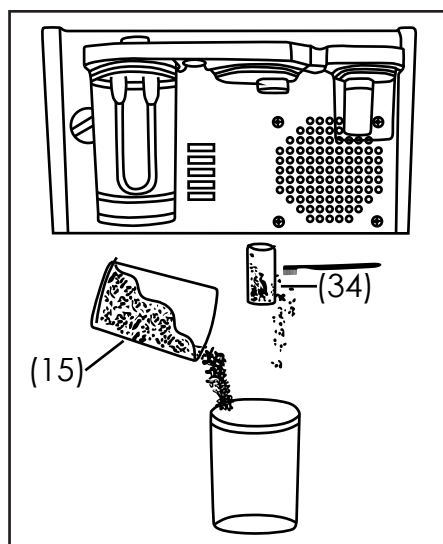

Picture 2

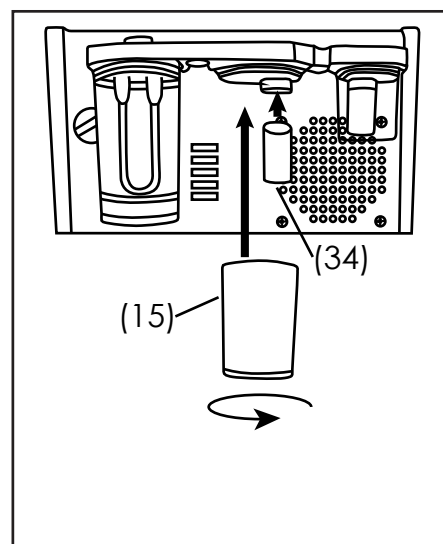

Picture 3

Unit Maintenance

Cleaning the crystal dermabrasion wand head:

1. Remove the plastic cover for the crystal wand head (32) (picture 1).
2. Use the tip cleaner (30) to clean the hole of the crystal wand (picture 2).
3. After cleaning, turn the anti-clogging switch (2) briefly to blow out any crystals in the system. **Note: Before turning the anti-clogging switch, make sure the wand head is not facing your eyes or anyone else's eyes.**

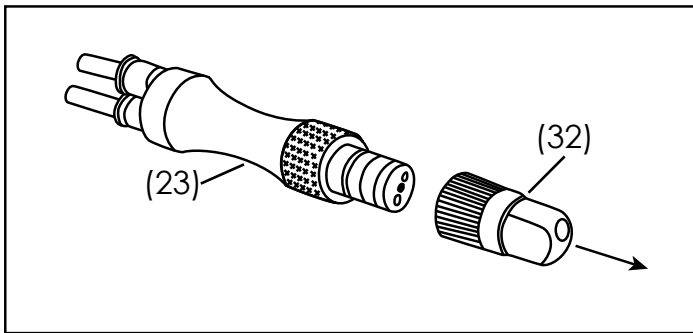

Picture 1

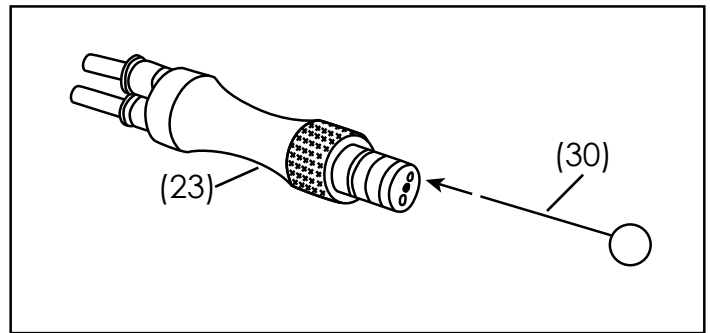

Picture 2

Unclogging the unit:

If performance has gone down, there may be some crystals stuck in the system. To unclog the unit, first perform the anti-clogging procedure outlined above in step 3 of cleaning the crystal dermabrasion wand head. Next:

1. Disconnect the wand tubes from the crystal recycle (8) and crystal output (9) sockets so that the crystal dermabrasion wand (23) is no longer connected to the unit.
2. Turn the anti-clogging switch (2) briefly to blow out any crystals in the system.
3. Reconnect the wand tubes to the crystal recycle (8) and crystal output (9) sockets. Tube A connects to socket A: Tube B connects to socket B. **Note: Before turning the anti-clogging switch, make sure the wand head is not facing your eyes or anyone else's eyes.**

Technical data:

Voltage: 120V

Frequency: 50Hz/60Hz

Power: 230W

Product information video: <https://youtu.be/cfz64z618FQ>