

SKIN+ACT

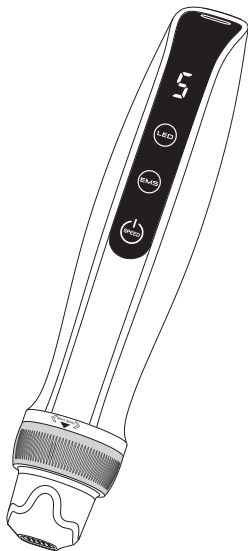

PRO WIRELESS MICRONEEDLING PEN

WITH EMS & LIGHT THERAPY

SKU24714

Please read the manual before use

Table of contents

Product description	2
Parts name	3
Introduction for wireless mode	4
How to charge the battery	4
How to operate	5
How to operate	6
Adjustment of needle length	7
Speed display and adjustment	7
How to use the inductive base	8
Needle cartridge introduction	9
Reference chart	10
Specification	10
Precaution	11
Warranty	12

Product description

The device consists of an electric microneedling pen, an inductive base and disposable needle cartridges. This manual will explain how to use each component in detail.

The device combines the technology of microneedling with microcurrent(EMS) and light therapy. There are 2 different types of needle cartridges designed for the device.

Microneedling technology improves the appearance of the skin and reduce signs of aging. It is intended to stimulate the skin with micro-needles for collagen and elastin production. The micro-channels created in the superficial skin by the device also help with the absorption of skin serums.

Microcurrent (EMS) can enhance the activity of cells, promote muscle movement, restore skin elasticity, and accelerate the blood circulation of capillaries.

Parts name

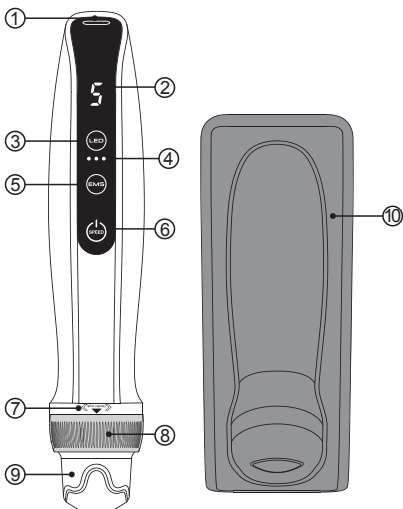

① Power Interface

② Speed Display

③ LED light button

④ EMS intensity display

⑤ EMS intensity button

⑥ Power/Speed button

⑦ Scale point

⑧ Scale adjustment ring

⑨ Needle cartridge

⑩ Inductive base

Introduction for wireless mode

This device is powered by a built-in battery. It can work wirelessly. The power cable and the adapter are used to charge the device when it is out of battery.

How to charge the battery

Connect the power cable with adapter to the power interface of device and plug the adapter into a live AC outlet to charge the device. Charging will complete in about 3 hours.

The number of speed flashes slowly when the battery capacity is 10% left .

The pen will turn off automatically after the number of speed flashes quickly for 1 minute.

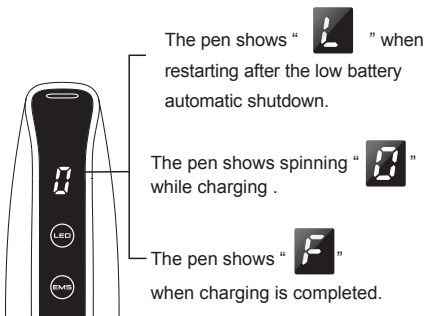

How to operate

Take out the needle cartridge from the sterilized packaging.

[Fig1]

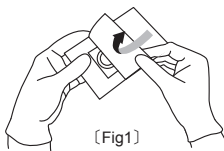

Place the needle cartridge in position and lock it onto the device by turning the needle cartridge clockwise. [Fig2]

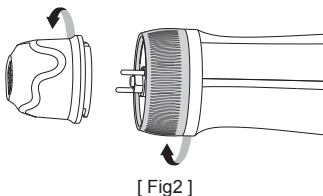

Turn the needle cartridge counterclockwise and pull it out when you would like to remove the cartridge. [Fig2]

Start the device only when the needle cartridge is assembled correctly. Press and hold the power button for 3 seconds to turn on/off the device.

How to operate

3 different levels for intensity of EMS.

Use suitable intensity according to the treatment and skin type. Change the intensity of EMS by pressing the EMS intensity button. The intensity of EMS varies with each press.

Level 1 for the intensity of EMS: 1 light on.

Level 2 for the intensity of EMS: 2 lights on.

Level 3 for the intensity of EMS: 3 lights on.

The EMS function closes when all lights are off.

Press the LED light button to start or shut down the light. The light color changes each time the button is pressed.

Red light: Reduce the inflammation and stimulate the production of collagen.

Blue light: Good for sterilization and improvement of acne.

Adjustment of needle length

Use suitable needle size according to different treatment areas and skin problems.

Adjust the depth of the needle by turning the scale adjustment ring. The depth of the needle should be adjusted after starting the pen. The scale number aligning with the scale point shows the current needle depth. [Fig3]

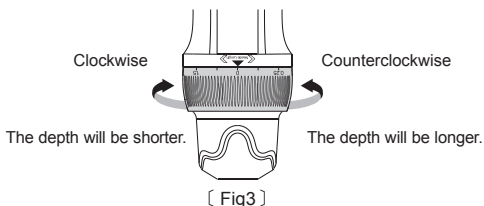

Speed display and adjustment

Speed Display



5 Speeds Adjustment

Press and hold the power button for 3 seconds to start or shut down the device. After starting the device, the speed changes once every time the power button is pressed.

How to use the inductive base

After the device is turned on and on the running state.

The device will stop working automatically when it stays on the inductive base. [Fig4]

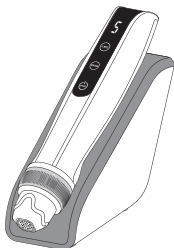

[Fig4]

The device will restart working automatically after leaving the inductive base. [Fig5]

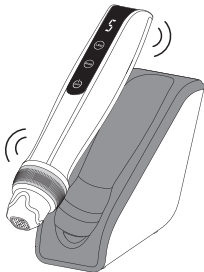

[Fig5]

Needle cartridge introduction



9 Needles



25 Needles

The needle cartridge is disposable.

The needle cartridge is designed for biopen Q2 only.

Please dispose the used needle cartridge to the trash container.

Place the used needle cartridge in a trash container.
If the needle cartridge is inadvertently contaminated during installation (i.e. Dropped on the floor, package opened/damaged.), please discard it and get a new needle cartridge.

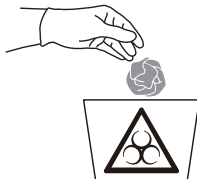

Reference chart

REGION	NEEDLE DEPTH (mm)
Forehead	0.25 - 0.5
Between the Eyebrows	0.25 - 0.5
Nose	0.25
Around the orbital rim	0.25
Cheek and Chin	0.5 - 1.5

Specification

Model name : SKU24714

Adapter

Input : 100-240V 50-60HZ Output : 5V $\overline{\text{---}}$ 1A

Package Weight : 625 g

Package Size : 194*146*67 mm

Packing List

Item	Quantity
Hand Piece	1 pc
Adapter	1 pc
Manual	1 pc
Power Cable	1 pc
Needle Cartridge	2 pcs
Inductive base	1 pc

Precaution

	Please be sure to read the instructions before use and follow as described.		
	Do not apply it to the person as following: 1. Who has acute disease or bloody disease over 38°C 2. Who has allergy and hemophilia 3. Who has melanosis of the face 4. Who has high internal heat 5. Who regularly visits hospital 6. Who takes medicines 7. Who is under 12 years old		
	Do not use it on the power other than AC 220V. It may cause fires or malfunction.		
	Do not use it near the place with high temperature, dust or humidity (Near the humidifier). It may cause malfunction.		
	Do not repair, disassemble or alter the controller and the body. It may cause malfunction.		
	Do not touch the device or detach the power cords with wet hands. It may cause electric shock.		
	Do not use the stripped cord or propped cord. It may cause fires(Be sure to replace it with another).		
	Do not use the propped cord which has crack or scares. It may cause scares on the skin.		
	When you don't use it for a long time, unplug it from the outlet.		
	Be sure to have an inspection for test. If any troubles are found, get it repaired.		
	No one other than the operator can touch it. It may cause accidents or malfunction.		
	Alternating current		Serial No
	Direct current		Manufacturer
	Date of manufacture		CE mark
	Attention, consult accompanying documents		Consult instruction for use

Warranty

The warranty period of the device is 12 months. We offer repair service from the purchase date. If any of our products has damages or natural trouble, we provide replacements or repair service. The use of third-party cartridges can cause damage to the device. This could invalidate the warranty.

General maintenance

Make sure to inspect the device and adapter before use.

Ensure the device is turned off when not in use. Wipe its surface with a disinfecting wipe.

Pay attention to clean areas such as crevices, seams, and areas around where the needle cartridge attaches to the device.

Keep it away from direct sunlight or high temperature or humidity.

Do not leave the measurement, repair or alter of the device to non-professional staffs.

When you use the device which has not been used for a long time, make sure to check if it works properly with safety.

SKIN+ACT

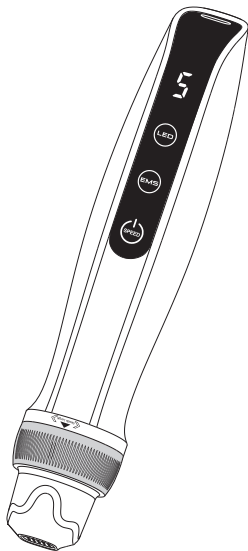

PRO WIRELESS MICRONEEDLING PEN

WITH EMS & LIGHT THERAPY

SKU24714

Please read the manual before use