

# Versa Hydraulic Bed/Chair/Table User Manual



Spa & Equipment SKINACT

Toll Free: 1.800.418.0830

[www.skinact.com](http://www.skinact.com)  
[www.spaandequipment.com](http://www.spaandequipment.com)

International: 818.834.6640

## NOTICE

No part of this document may be photocopied, reproduced, or translated into any other language without prior written consent of Spa and Equipment/SkinAct.

The information in this document is subject to change without notice at any time and should not be construed as a commitment by Spa and Equipment/SkinAct.

Spa and Equipment/SkinAct assumes no responsibility for any errors that may be in this document, nor does it make expressed or implied warranty with regard to this material, including, but not limited to, the implied warranties of merchantability and fitness for a particular purpose.

Spa and Equipment/SkinAct shall not be liable for incidental or consequential damages arising out of the furnishing, performance, or use of this document and the program material which it describes.



Toll Free: 1.800.418.0830

[www.skinact.com](http://www.skinact.com)  
[www.spaandequipment.com](http://www.spaandequipment.com)

International: 818.834.6640

# Precautions

- Read this manual carefully before installation and operation.
- No one should ever sit on the back rest or foot rest sections.
- This unit should only be operated by trained professionals.
- Keep children from using or playing on the unit.
- Do not stand on any portion of the unit.
- Ensure the unit is kept dry and free of water.
- When operating the unit, ensure that your and your clients' hands or other body parts cannot be pinched by the moving parts (see pinch points below).
- If you have gone through the troubleshooting steps in this manual and an issue persists, please call Spaandequipment/SkinAct for further assistance: 1(800)418-0830
- **OPERATE AT YOUR OWN RISK AND USE COMMON SENSE: OWNER/OPERATOR IS RESPONSIBLE FOR HIS/HER OWN SAFETY AS WELL AS ANYONE NEAR OR ON THE UNIT.**

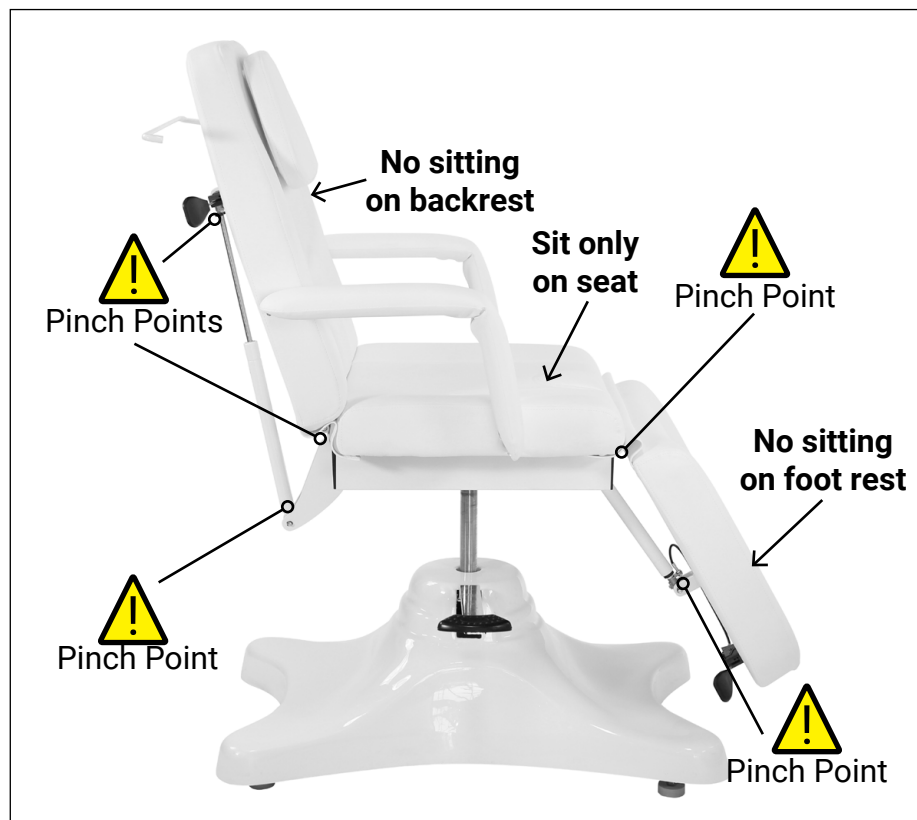

# Removing From The Box

- To see a video about removing your item from the box, visit <https://youtu.be/OGIz0NLdW1I> or scan the QR code below.



Scan to see  
video

## INSTRUCTIONS

- When you receive the box, carefully cut the tape on the top flaps and open the top (see photo below).



- Then you can cut one short side of the box and lay it down. This makes it easier to carry the item out of the box.
- **Make sure to cut from the inside of the box.** This helps to protect from accidentally cutting your unit.

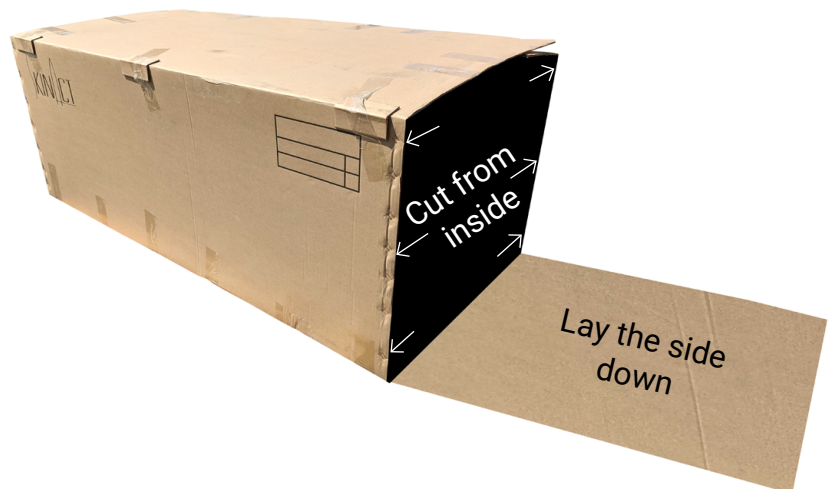

# Removing From The Box

- **Please keep all packaging materials.** This helps in the event that you need to return the unit for whatever reason.
- **TEAM LIFT:** Make sure to have at least two people to lift and move the unit.
- Do not lift from the head rest or foot rest areas.
- For this unit, it is best to lift with both hands on the metal base directly underneath the seat cushion.

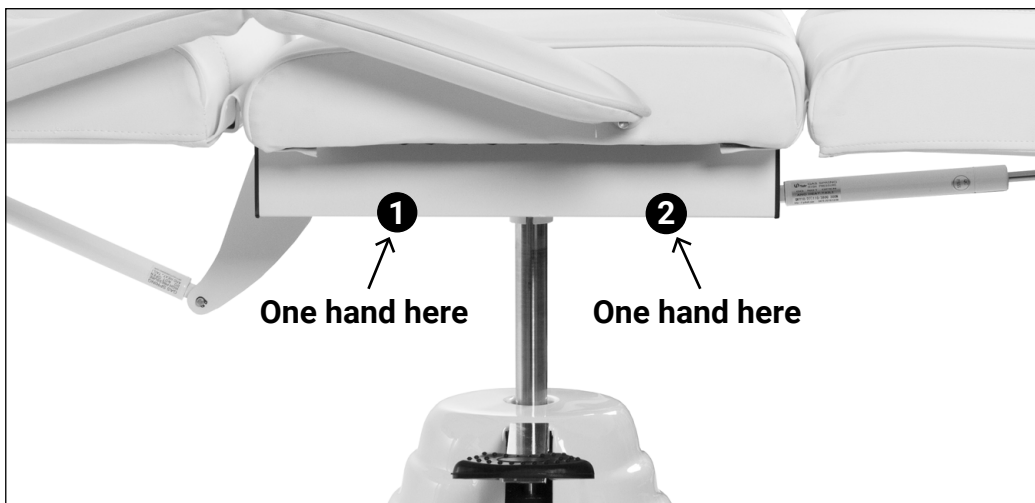

- Lift the unit with your partner and walk it out of the box.
- We recommend setting the unit on a furniture dolly or pallet jack when and where it is practical to use one. Otherwise, you can carry the unit to your desired location.



# Installation

- Please keep all packaging until you test all the functions.
- Place the unit in the desired location in your space. Attach the arm rests, head rest, and any other accessories.
- Ensure the ground below the bed is flat and not wet or slippery.

## Leveling The Base

- All of our hydraulic chairs come with leveling feet on the bottom of the base. These are super useful when the floor below is slightly uneven.
- This chair has four leveling feet, one at each corner of the base.
- If the base of your chair rocks back and forth, adjust the leveling feet by spinning them to raise or lower them. The foot that clears the floor when you rock the table is the one that will need adjustment.

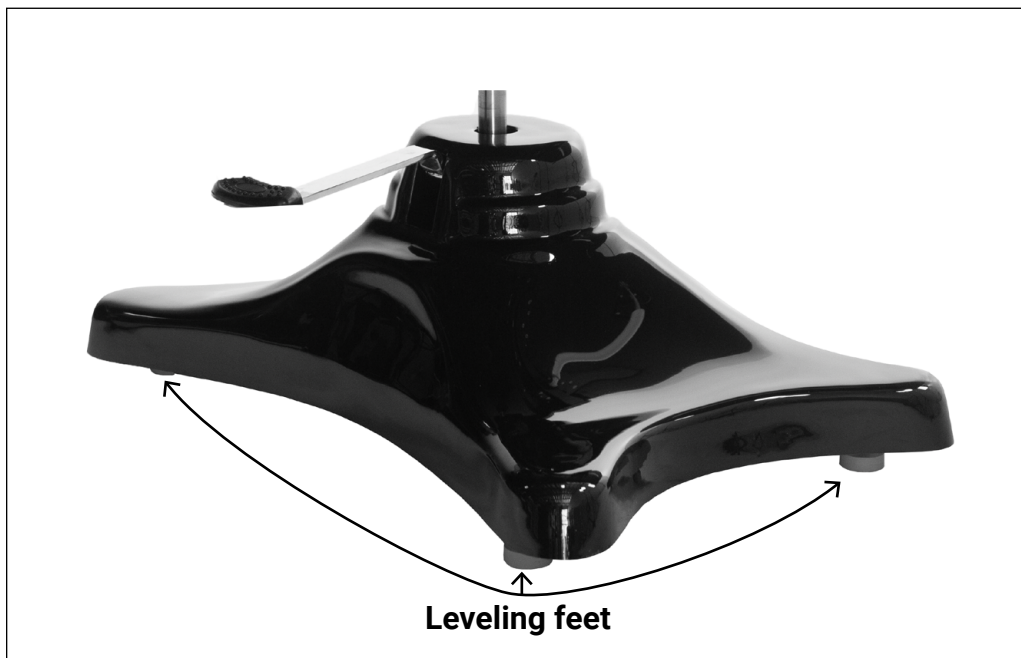

# Adjusting The Backrest and Foot Rest

- **NOTE: When adjusting the backrest or foot rest, always keep a hand on the backrest or foot rest to avoid abrupt movements.**
- The Versa is equipped with air-gas pump technology to help with adjusting the backrest and foot rest angles. The air-gas technology is similar to that which is used to lift automobile rear hatches with ease.
- To adjust either the backrest or foot rest, push the black lever towards the cushion (see picture below) to disengage the pump. Then you can adjust the cushion angle. When you reach your desired angle, release the black lever and the cushion will stay in its place.





# Adjusting The Chair Height

- All our hydraulic units come with a foot pump for raising and lowering the chair.
- To raise the chair simply pump the foot pedal down multiple times rapidly until the chair is at its desired height.

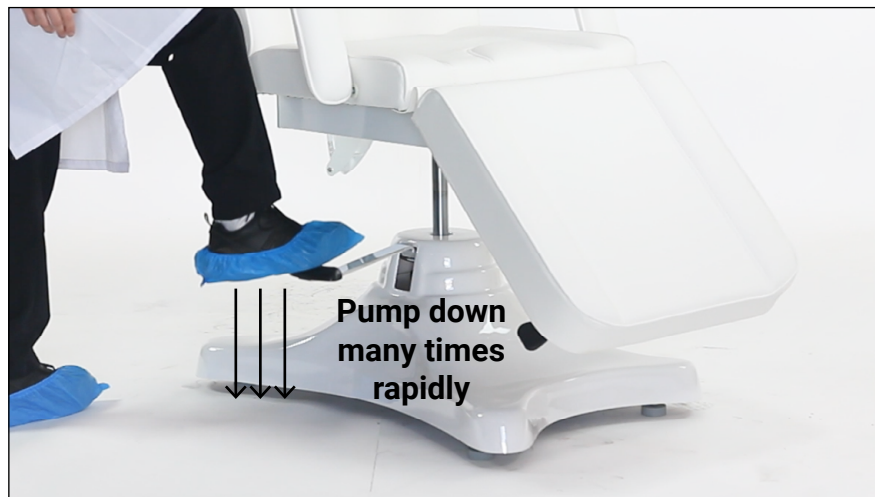

- To lower the unit, push the pedal all the way down and hold it down. The chair will lower and you can take your foot off the pedal when it reaches the height you desire or when it reaches its lowest height.





# Courtesy Stopper

- All our hydraulic units have a “courtesy stopper.” The stopper helps to stop the chair from quickly spinning accidentally. It does not lock the rotation but it does make it harder to spin.
- To engage the courtesy stopper, simply lift the foot pedal up towards the ceiling with your foot until it does not go higher.



---

## Getting On and Off

- The backrest should be up and the foot rest should be down.
- Have the courtesy stopper up when a client gets on or off.
- Also, we recommend removing one of the arms so that it is easier to get on and off the seat cushion.
- Keep a hand on the back rest when they get on or off.



# Safe Use

- Once a client is on, we recommend keeping the courtesy stopper up whenever the chair does not need to rotate.
- For the most stability, keep the top portion of the chair in line with the base.

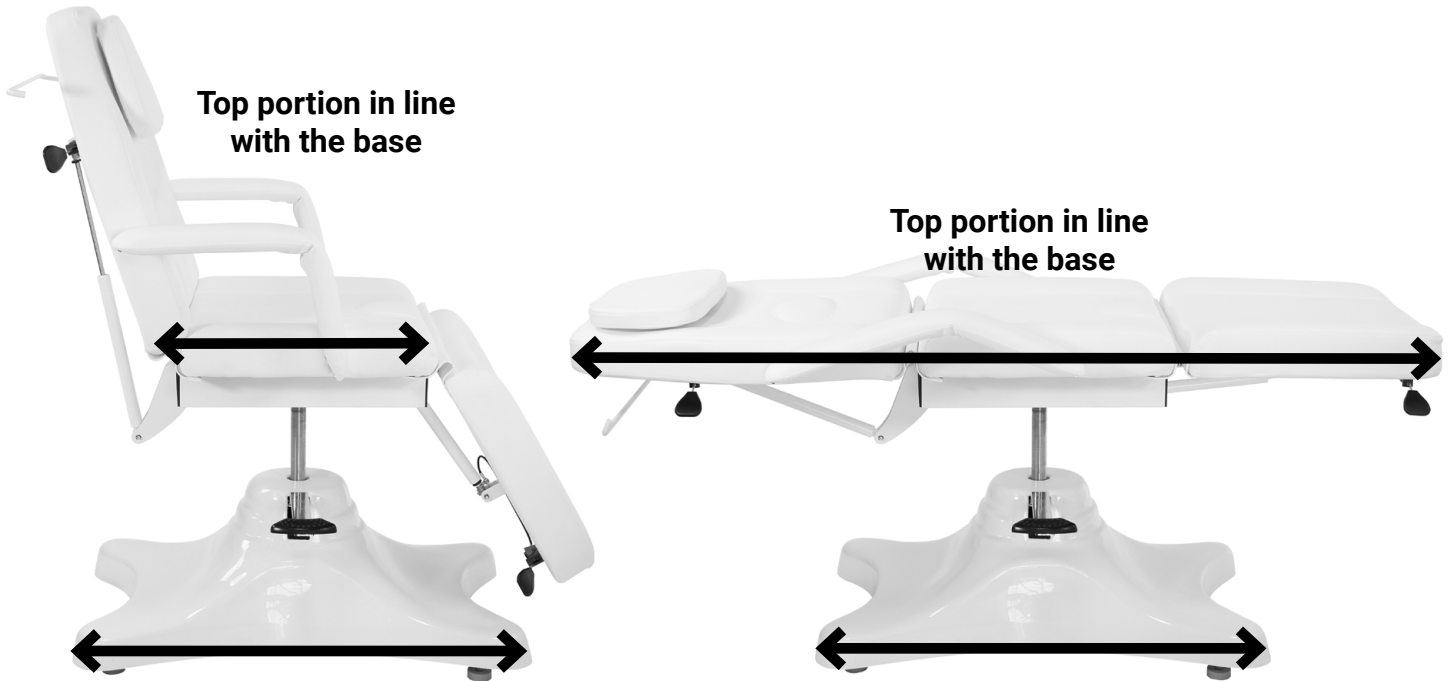

- If you need to rotate the chair with the client on, bring the backrest up and the foot rest down. Make sure to rotate slowly with both hands on the head portion of the backrest.
- **NOTE: Do not rotate the bed from the middle seat section. Rotating from there can make the chair rotate too quickly.**
- If you have to rotate the chair when it is in the flat position, you must hold the headrest from underneath as you are rotating until the top portion of the chair is in line with the base again.
- Hydraulic chairs are not designed for massage.
- To see a video about using your chair safely, you can visit <https://youtu.be/ksHLHSCsC50> or scan the QR code below.



Scan to see  
video

# Measurements



# Measurements



## Dimensions/Specifications

- Length: 71"
- Width without arm rests: 24"
- Width with arm rests: 31.5"
- Heights: 23" - 29.5"
- Base dimensions (BASE ONLY): 37.5" x 24"
- Backrest angle: 0° flat to 72° incline
- Leg rest angle: 0° flat to 60° decline
- Capacity of 300 lbs
- Cushion thickness: 4"
- Colors available: White or Black
- Unit arrives fully assembled
- Comes with a FREE beauty stool in matching color
- Rotates 360°
- Removable pillow
- Leveling feet on base

\* All height measurements are from the ground to the top of the cushion \*

\*\* All measurements have a 0.25 to 0.75 inch tolerance \*\*

## Maintenance

- When cleaning and sanitizing, **do not use bleach, Barbicide, or other harsh chemicals**. Using harsh chemicals can damage the upholstery.
- Simple Green or upholstery cleaners work great for cleaning the upholstery. Lysol wipes work well for sanitizing the upholstery.
- Clean and sanitize the upholstery after each treatment.
- Every six months, visually inspect the parts of the unit. If there are any abnormal noises or vibrations during operation, call Spa and Equipment/SkinAct and describe the situation.

# Troubleshooting

Issue	Possible Reason	Solution
Chair base wobbles	Floor is not flat	1) Adjust leveling feet (see page 9)
	Leveling feet are different heights	1) Adjust leveling feet (see page 9)
Backrest/leg rest sections cannot be adjusted	Cable for air-gas pump needs adjustment	1) View repair video (see below) and follow instructions 2) If the issue persists, call Spa and Equipment/SkinAct Technical dept: 1(800)418-0830

Scan for air-gas  
pump cable repair  
video



Or visit <https://youtu.be/A3GdctYS5Ds>

---

## Warranty

- This item has a 1-year limited warranty for malfunctions and manufacture defects only (parts, labor, and shipping not included). **THIS WARRANTY IS VOID IN THE EVENT EQUIPMENT IS DAMAGED BY IMPROPER USE.**
- To read the full Warranty Policy, please visit <https://www.spaandequipment.com/Return-Warranty-Repair-Policy.html> or scan the QR code below.

Scan for  
warranty

